

CWDM System Chassis



Model CL-5000

CL-5000 System Chassis is a Card Cage combined with built-in CWDM optical trunking multiplexer that supports up to 8 CWDM wavelengths of Simplex or Duplex optical signals over one strand of the fiber. The CL-5000 employs separate optical channels for each optical link, which enhances network security by completely isolating the each channel. The CL-5000 houses modules, which access the internal CWDM fiber system.

The CL-5000 has easy-to-read diagnostic LED's for the LAN and WAN port's optical link status. The CL-5000 has an SNMP option for remote monitoring. The CL-5000 uses standard SC or SC/APC fiber optic connectors and is IEEE 802.3z 1000BASE-FX compliant and operates with all devices that adhere to this standard.

Features

- 2 to 8 Full Duplex signals on 1 Fiber
- Hot Swap Modules
- Hot Swap, Load Sharing Power Supplies for 110V AC, 240V AC or 48V DC
- SNMP option
- 20 to 110km Transmission Range (Model Selection)
- 1 or 2 Fiber Strand Transmission
- IEEE 802.3z compliant

Available Modules

- Gigabit Ethernet TX to LX
- Gigabit Ethernet SX to LX
- Dual Gigabit Ethernet SX to LX
- 30 Mbps - 2.7 Gigabit Programmable Repeater
- IF Frequency Digitizer
- Video/Audio Multiplexer
- DVB-ASI: 1 Channel, 2 Channel
- DS1, DS3, OC3, E3
- Fast Ethernet

Model Selection

CL-5000CC-CWDM-1S-4PD-SCA-0	CWDM Card Cage, 2 PortSimplex, 1310, 1510-1570nm, Single Fiber, SC/APC Connector
CL-5000CC-CWDM-1S-8PD-SCA-0	CWDM Card Cage, 4 PortDuplex, 1310, 1470-1610nm, Single Fiber, SC/APC Connector
CL-5000CC-CWDM-1S-4PS-SCA-0	CWDM Card Cage, 8 PortSimplex, 1470-1610nm, Single Fiber, SC/APC Connector

Other Connectors and Distances Available Upon Request

Example Application

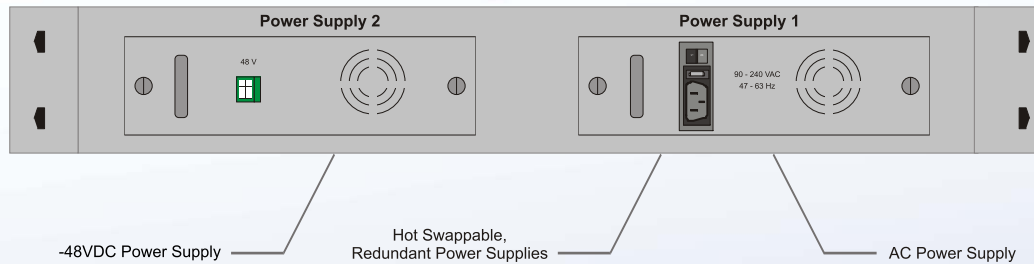

Specifications

Standards	19" Rackmount Card Cage, 2U High
Network Media	RJ-45 (Optional SNMP Monitoring Port)
LED Indicators	PS1 Power, PS2 Power
Dimensions	17" x 10" x 3.50"
Environment	Operating temperature: 0°C to 50°C Storage temperature: -20°C to 70°C Operating humidity: 10% to 90% RH Storage humidity: 5% to 90% RH
Input Power Requirements	Voltage: 110/240V Auto-sense Internal Power Optional Redundant, Load Sharing 48V DC Supplies